

Typical for Remodel

--- FOR REFERENCE ONLY ---
This drawing does not necessarily
Comply with current building code.

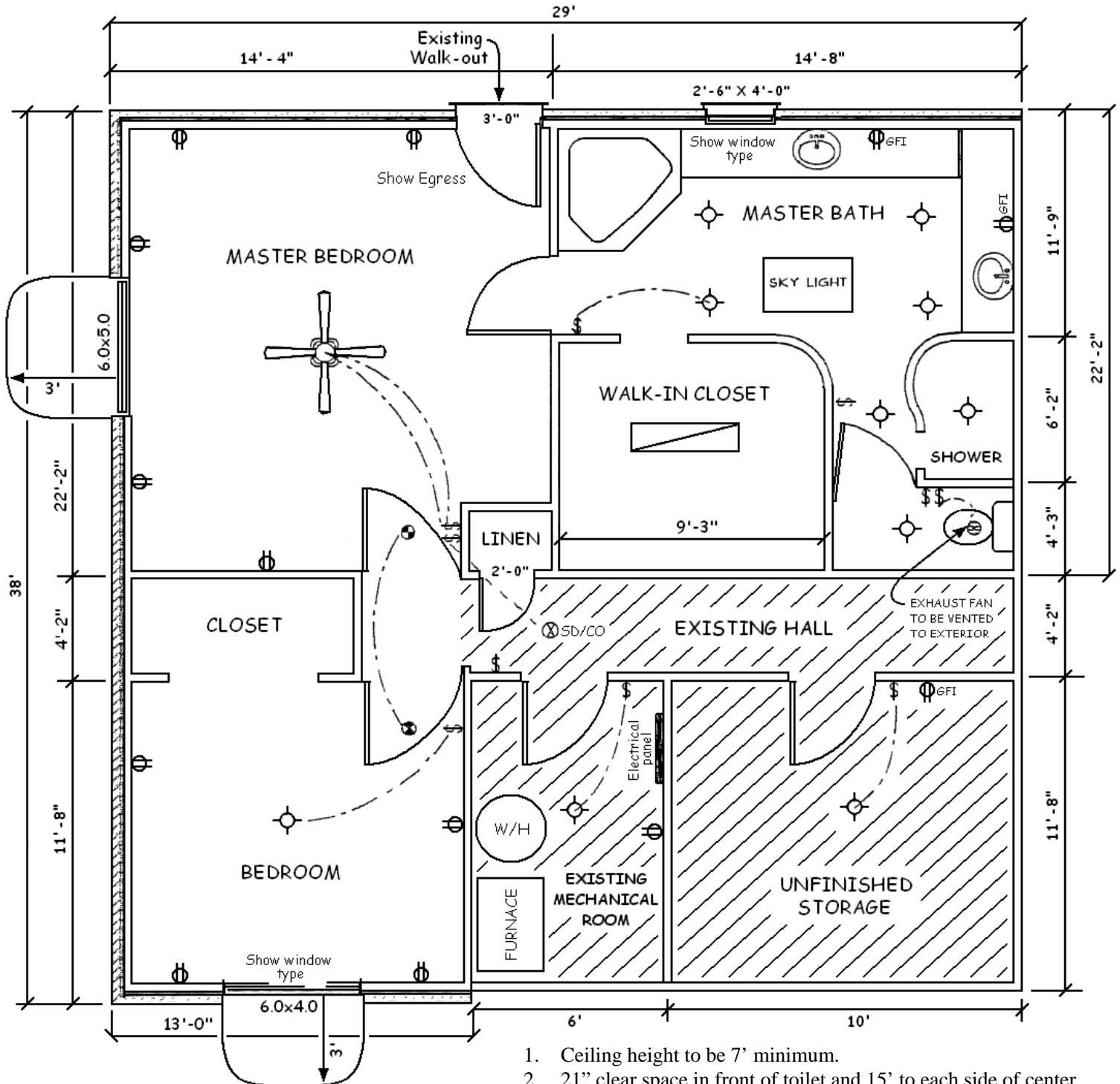

- ⊕ = Electrical Outlets
- ⊙ = Light Fixture
- ⌘ = Light Switch
- ⦿ = Smoke Detector
- ⊗SD/CO = Combination Carbon Monoxide/Smoke Detector

1. Ceiling height to be 7' minimum.
2. 21" clear space in front of toilet and 15' to each side of center.
3. 900 square inch shower floor area and min. 30" dimension on one side. Min. 22" door with a min. 24" in front of door.
4. Receptacle outlets must be provided so any point along a wall does not exceed 6' distance to an outlet.
5. Small wall sections between doors require an outlet when 2 ft. or wider.
6. AFCI protection is needed for all bedroom outlets.
7. Insulation to be at least R-13 in walls. In most applications of insulation, a vapor barrier is not needed. Please note this on your plans.
8. Note that all exterior walls are to be fireblocked horizontally and vertically in 10' compartments.

**Total Sq. Ft. of area
being finished _____**

Typical for Remodel

--- FOR REFERENCE ONLY ---
 This drawing does not necessarily
 Comply with current building code.

